

INSTALLATION / USER MANUAL
Human presence detection module

**HEY YOU,
LET ME
HELP!**

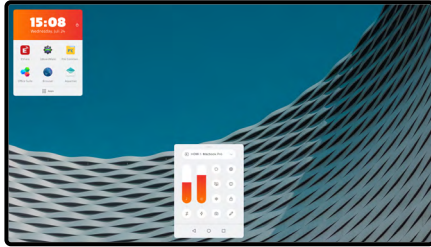

Open the Float Bar

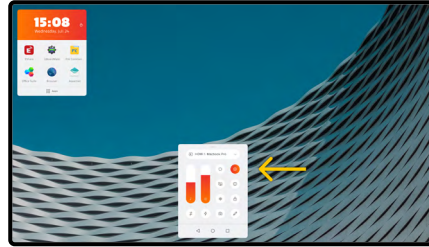

Go to the Settings Menu

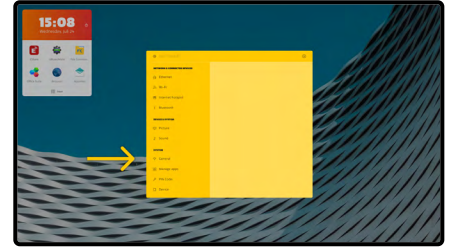

Go to General

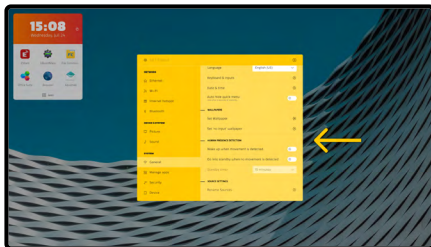

Go to Human Presence Detection

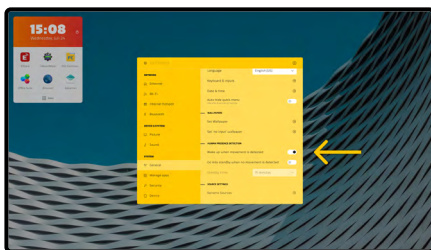

Set the required settings

- a. Wake up when motion is detected.
 - i. This option will make the screen turn itself on when movement is detected by the Human Presence Detection module.
 - ii. **Note:** there is no timer to be set, the display will turn itself on instantly.

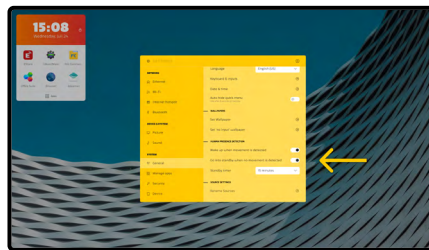

- b. Go to stand-by when no motion is detected.
 - i. This option will make the screen go into stand-by when no movement is detected by the Human Presence Detection module.

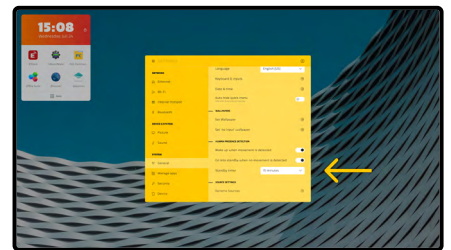

- c. Motion standby timer.
 - i. Here you select the time needed between the last movement detected by the Human Presence Detection module and switching into stand-by mode.